

# Protero

## **DUMP N' GO MODEL PV 212 JOHN DEERE**

---

8722 E Research Center Rd.  
New Hope, MN 55428  
Ph: 763-535-4038  
Fax: 763-535-4633



PV 212 shown on John Deere Model X500  
Fits models: LX/GT and GX

---

## **ASSEMBLY INSTRUCTIONS AND PARTS LISTS**

# SAFETY

Congratulations on purchase of your Protero PV 212 Dump N Go grass catcher!  
You will stay on your tractor seat and enjoy a beautiful lawn for a long time to come.

Please read and be familiar with the operator's manuals that came with your mower and grass catcher. These manuals provide information for the safest and most effective use of your equipment. If you do not have operator's manuals for your mower and for your collection system, please contact your dealer to obtain them.

The Dump N Go catcher simply replaces the bag-type catcher in your collection system; so all safety guidelines in your operator's manual for the collection system apply to your Dump N Go as well. Do not operate, nor allow others to operate your Dump N Go catcher without thorough review and training of these important safety guidelines.

For your convenience, here are some basic safety guidelines that your operator's manuals will cover:

## **Before you operate your material collection system:**

- Understand the machine safety labels, and pay attention to the symbols for DANGER, WARNING, and CAUTION.
- WARNING: Objects may be thrown from mower.
- Do not open catcher while blades are turning.
- Shut off engine if getting off mower to inspect catcher.
- Operate mower with complete bagging attachment in place
- If necessary, use proper front counterweight. Remove counterweight when the material collection system is removed.
- Hopper extends beyond vehicle. Be aware of surrounding objects when making short turns.
- Do not operate material collection system unless entire grass catcher is fastened in place with the hopper cover securely latched.
- Do not let anyone ride on the mower or material collection system. Riders are subject to injury such as being struck by foreign objects or being thrown off. Riders may obstruct the operator's view and cause a collision.

## **Before you inspect catcher or unplug chute:**

- Stop mower.
- Disengage mower PTO.
- Stop engine.

## **Before you back up:**

- Stop machine.
- Look behind hopper for children or pets.

## **Operate safely on slopes:**

- Dump catcher when half full.
- Do not operate on steep slopes.
- Before you turn, slow down.
- Avoid holes, rocks, and roots.
- Mow up and down - not across slopes.
- Do not park mower with material collection system on slopes.

### **Parking Safely:**

- Stop machine on a level surface, not a slope.
- Disengage PTO.
- Wear close fitting clothing and safety equipment appropriate for the job.
- Always wear safety goggles or safety glasses with side shields when operating the machine.
- Wear a suitable protective device such as earplugs. Loud noise can cause impairment or loss of hearing.
- Do not wear radio or music headphones. Safe service and operation requires your full attention.

### **Practice Safe Maintenance:**

- Understand service procedures before doing work. Keep area clean and dry.
- Never service or adjust any part of the collection system while the mower is moving. Keep safety devices in place and in working condition. Keep hardware tight.
- Keep all parts in good condition and properly installed. Fix damage immediately. Replace worn or broken parts. Remove any buildup of debris.
- Unauthorized modifications to the collection system may impair its function and safety. Do not tamper with its original design.

# INCLUDED PARTS AND HARDWARE:

## TOOLS NEEDED:

- Phillips head screwdriver
- Two, 7/16" wrenches (7/16" socket and ratchet suggested)
- Two, 9/16" wrenches (9/16" sockets and ratchets suggested)
- 15/16" wrench (15/16" sockets and ratchets suggested)
- Pliers

## PARTS:

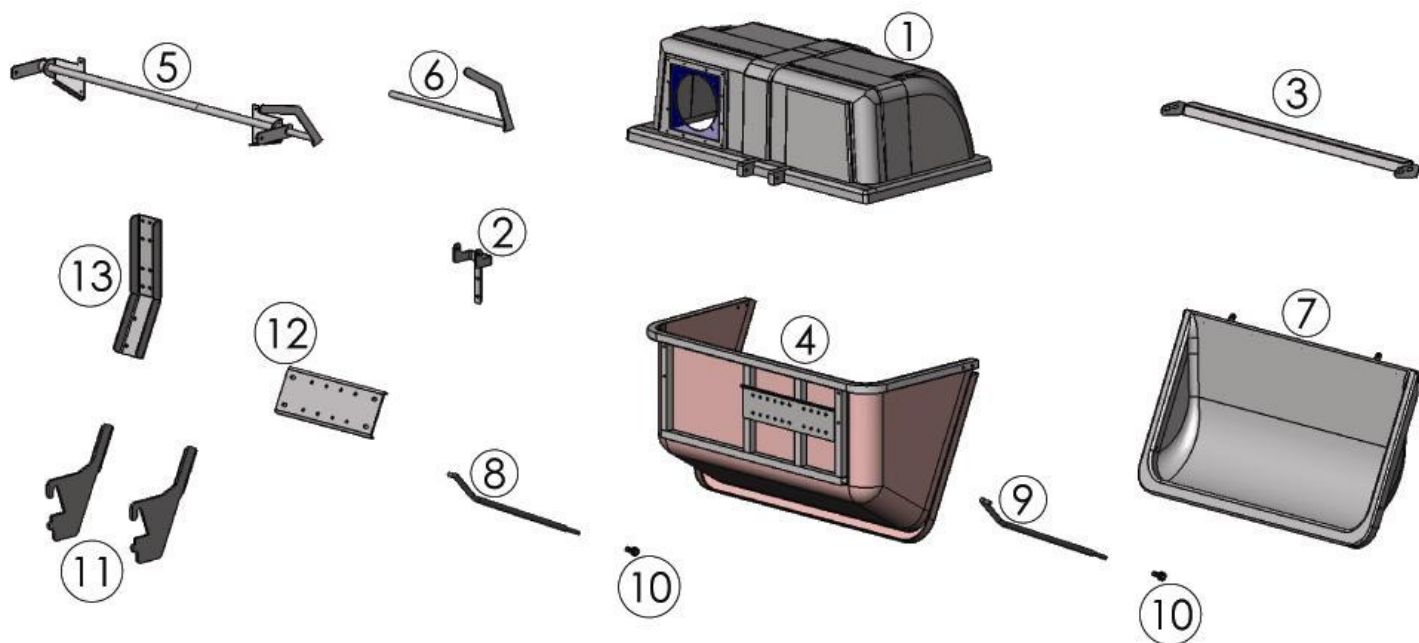

| ITEM # | PART # | DESCRIPTION                  | QUANTITY |
|--------|--------|------------------------------|----------|
| 1      | 212110 | 212 HOOD ASSEMBLY            | 1        |
| 2      | 212118 | 212 HINGE BRACKET            | 1        |
| 3      | 212140 | CATCHER HINGE ASSEMBLY       | 1        |
| 4      | 212150 | PV 212 CATCHER BODY ASSEMBLY | 1        |
| 5      | 212155 | DUMP LEVER ASSEMBLY          | 1        |
| 6      | 212156 | DUMP LEVER HANDLE            | 1        |
| 7      | 212160 | DOOR ASSEMBLY                | 1        |
| 8      | 212171 | HINGE ROD RIGHT              | 1        |
| 9      | 212172 | HINGE ROD LEFT               | 1        |
| 10     | 212175 | 3/8" BALL JOINT ROD END      | 2        |
| 11     | 212347 | JD GT/GX SIDE MOUNT          | 2        |
| 12     | 212345 | JD X300/X500 CROSSPLATE      | 1        |
| 13     | 212413 | 212 CHANNEL MOUNT (ANGLED)   | 1        |

# **HARDWARE INCLUDED:**

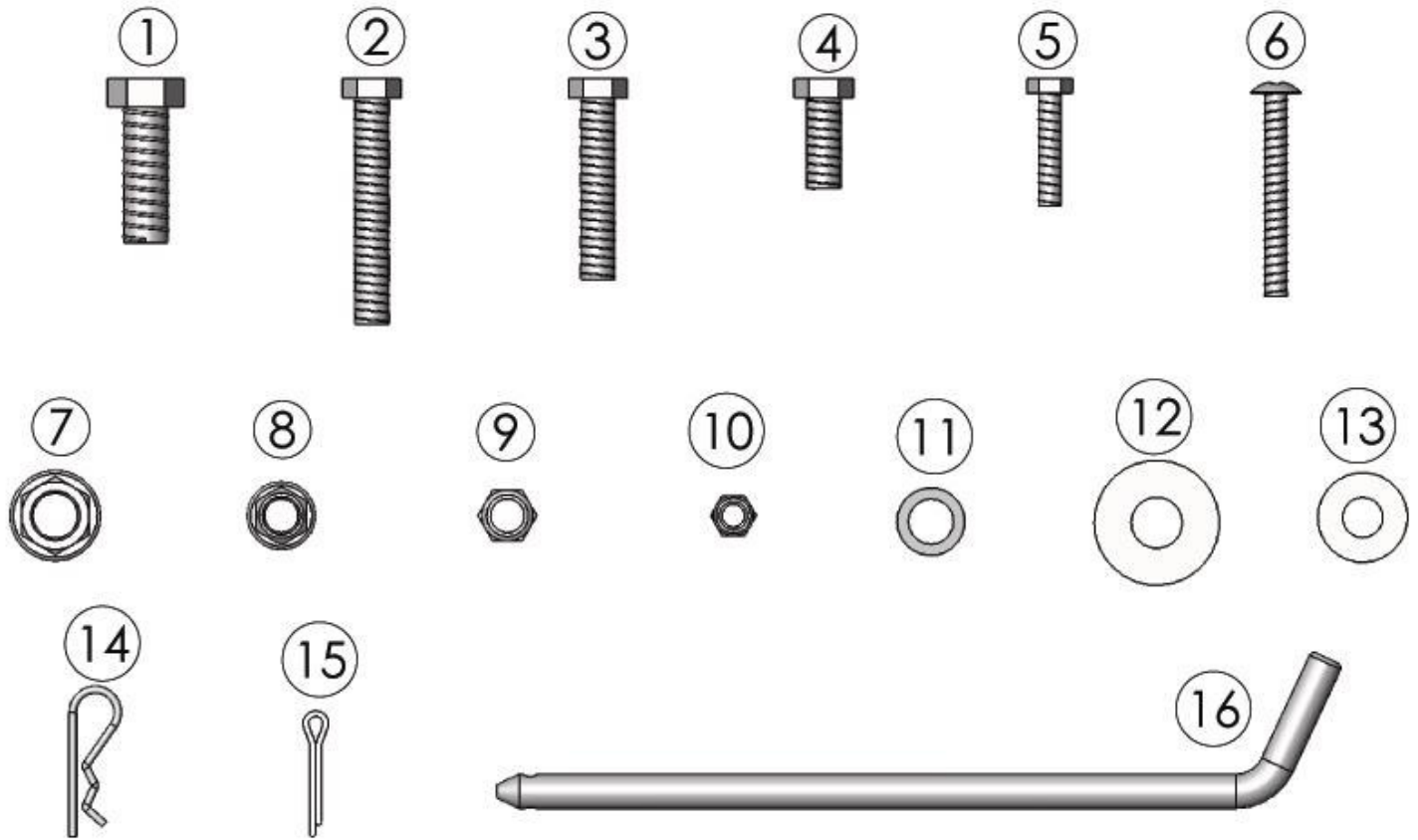

| ITEM # | PART #               | DESCRIPTION                            | QUANTITY |
|--------|----------------------|--|----------|
| 1      | BOLT HH 12 112       | 1/2" x 1 1/2" HEX HEAD BOLT            | 4        |
| 2      | BOLT HH 38 212       | 3/8" x 2 1/2" HEX HEAD BOLT            | 2        |
| 3      | BOLT HH 38 2         | 3/8" x 2" HEX HEAD BOLT                | 4        |
| 4      | BOLT HH 38 1         | 3/8" x 1" HEX HEAD BOLT                | 16       |
| 5      | BOLT HH 14 114       | 1/4" x 1 1/4" HEX HEAD BOLT            | 1        |
| 6      | BOLT PT 14 212       | 1/4" x 1 1/4" PHILLIPS TRUSS HEAD BOLT | 4        |
| 7      | FLANGE NUT 12        | 1/2" SERRATED FLANGE NUT               | 4        |
| 8      | FLANGE NUT 38        | 3/8" SERRATED FLANGE NUT               | 14       |
| 9      | NUT NYL 38           | 3/8" NYLOCK NUT                        | 8        |
| 10     | NUT NYL 14           | 1/4" NYLOCK NUT                        | 5        |
| 11     | 12 ID 34 TUBE SPACER | 1/2" x 3/4" TUBE SPACER                | 4        |
| 12     | WASHER 12            | 1/2" WASHER                            | 4        |
| 13     | WASHER 38            | 3/8" WASHER                            | 20       |
| 14     | BP 233               | BRIDGE PIN 0.930" x 1 1/8" ZINC        | 1        |
| 15     | COTP 125 1           | COTTER PIN 1/8" x 1" ZINC              | 2        |
| 16     | BNTP 375 725         | BENT PIN 3/8" x 7 1/4" EFF HOLE ZINC   | 1        |

# ASSEMBLY:

## STEP 1:

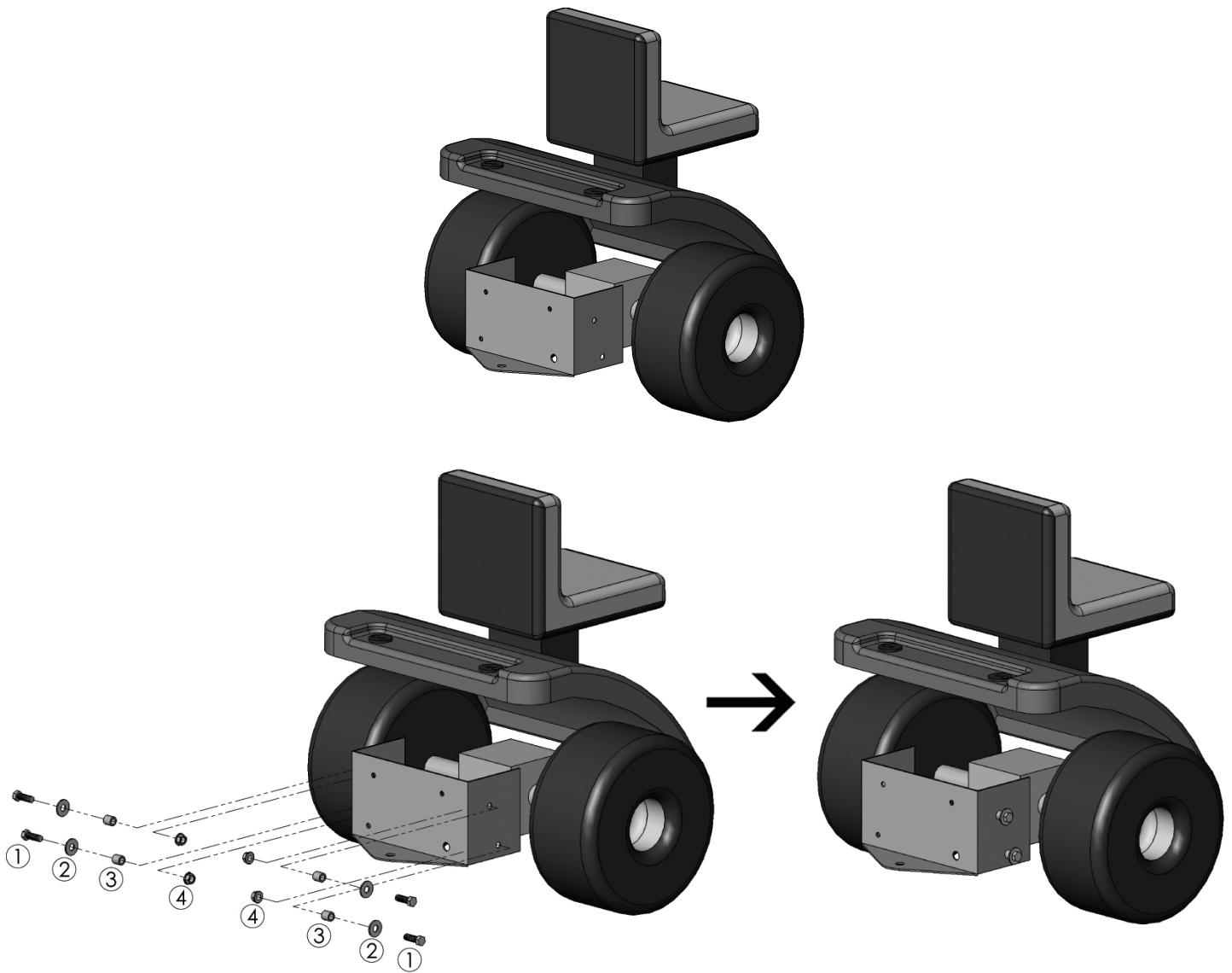

- (1) 1/2" x 1 1/2" hex head bolt (x4)
- (2) 1/2" washer (x4)
- (3) 1/2" ID tube spacer (x4)
- (4) 1/2" serrated flange nut (x4)

- Insert a 1/2" washer, then 1/2" tube spacer over a 1/2" bolt.
- Insert the bolt into each side of the rear plate.
- Fasten the bolts with 1/2" nuts from the inside of the rear mower plate.

**STEP 2:**

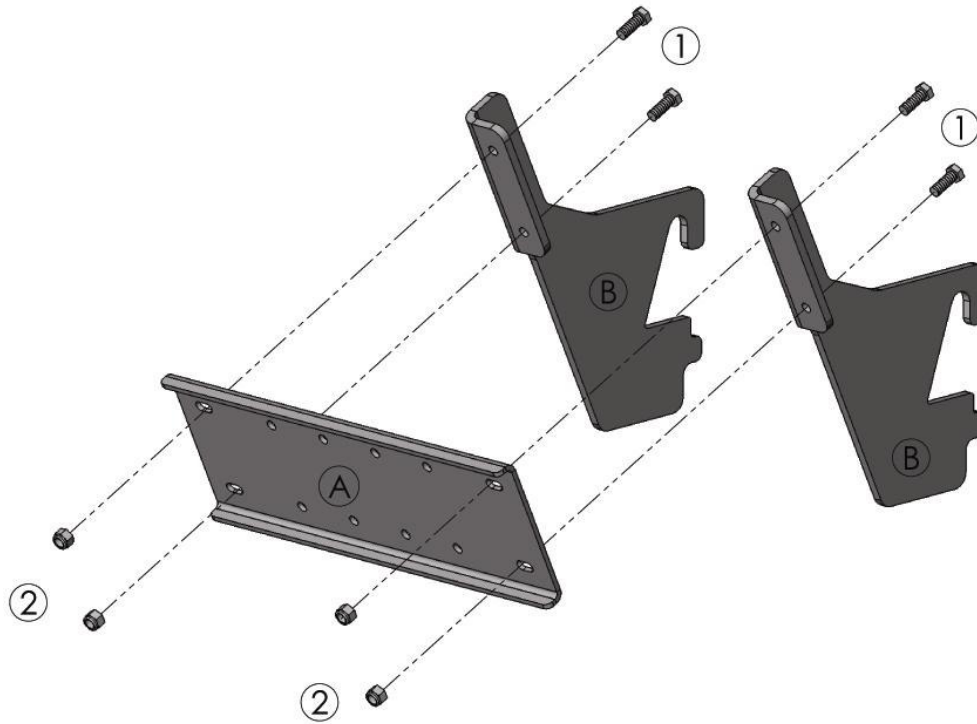

- (A) X300/X500 Crossplate
- (B) GT/GX Side Mount (x2)
- (1) 3/8" x 1" hex head bolt (x4)
- (2) 3/8" serrated flange nut (x4)

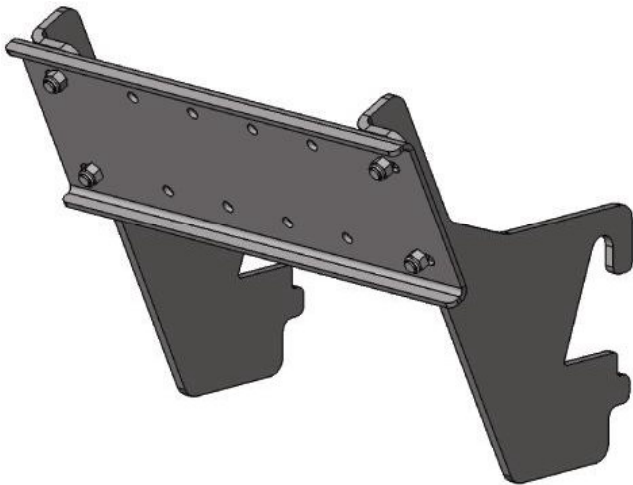

- Place the GT/GX Side Mounts against the X300/X500 Crossplate.
- Align the holes of the Side Mounts with the slotted holes of the Crossplate.
- Insert the 3/8" bolts through the holes of the Side Mounts and through the slotted holes of the Crossplate.
- Fasten the bolts with 3/8" nuts.

**STEP 3:**

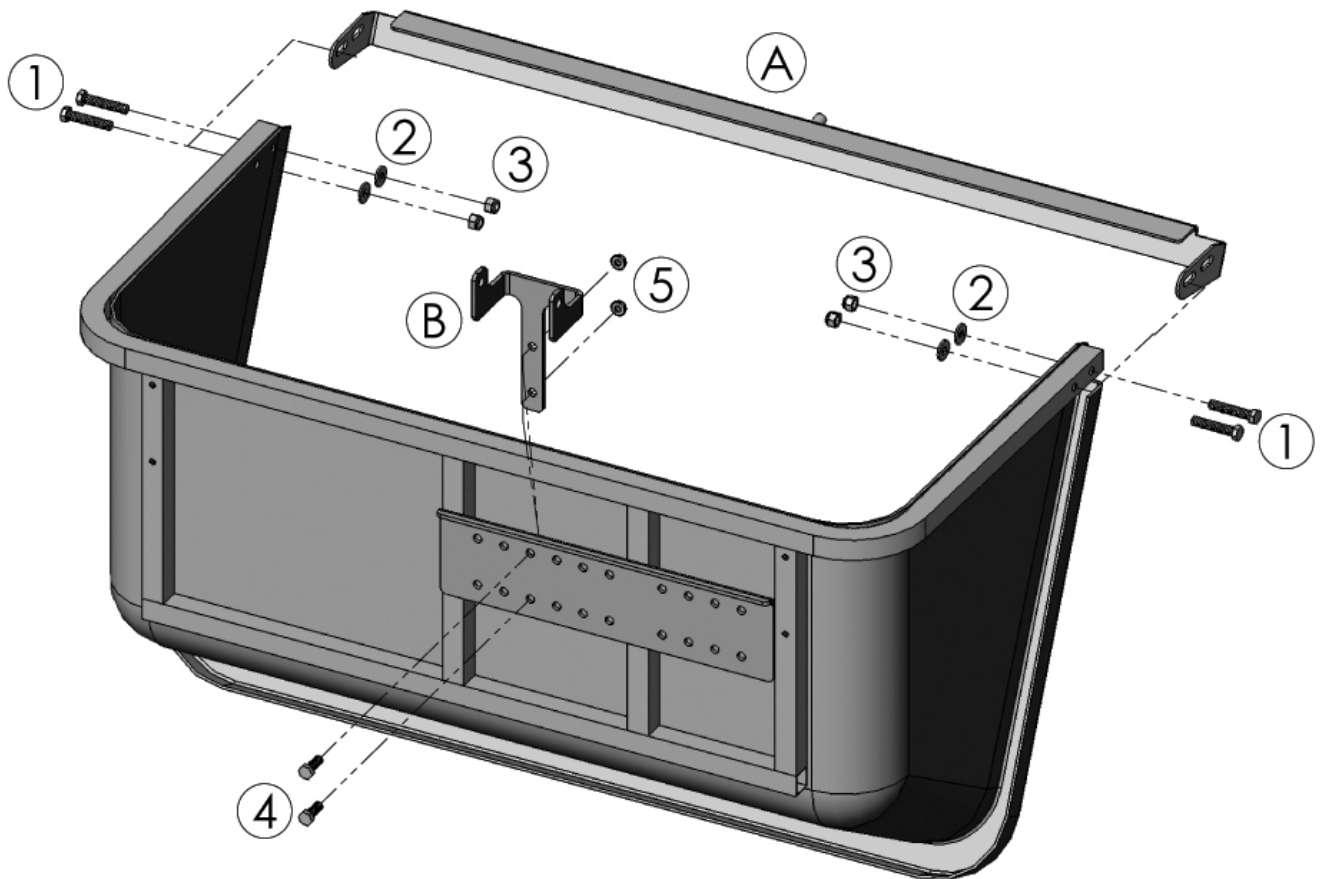

- (A) Catcher Hinge Assembly
- (B) 212 Hinge Bracket
- (1) 3/8" x 2" hex head bolt (x4)
- (2) 3/8" washer (x4)
- (3) 3/8" nylock nut (x4)
- (4) 3/8" x 1" hex head bolt (x2)
- (5) 3/8" serrated flange nut (x2)

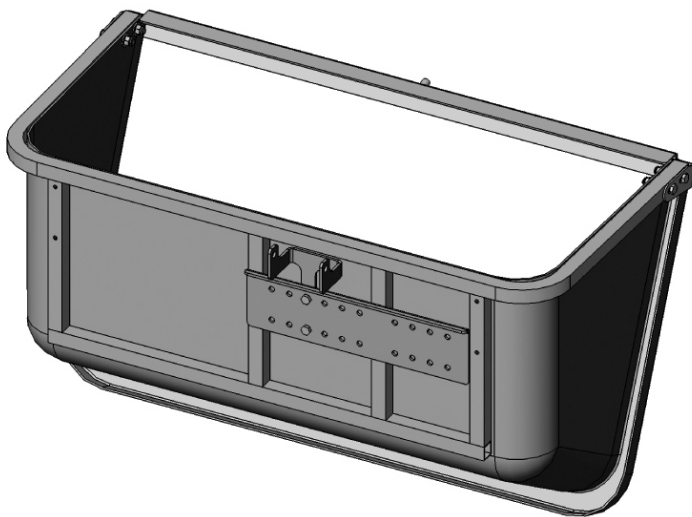

- Position the slotted holes of the Catcher Hinge Assembly to the holes on the PV212 Catcher Body sides.
- Insert the 3/8" x 2" bolts through the Catcher Hinge Assembly and Catcher Body.
- Place 3/8" washers on the bolts, from inside of the Catcher Body.
- Fasten bolts with 3/8" nylock nuts.
- Slide the 212 Hinge Bracket behind the plate attached to the frame of the Catcher body.
- Use the 3<sup>rd</sup> set of holes from the left and insert the 3/8" x 1" bolts through the holes.
- Reach behind the plate and Hinge Bracket and thread the 3/8" serrated flange nuts to the bolts and tighten the bolts.



**STEP 4:**

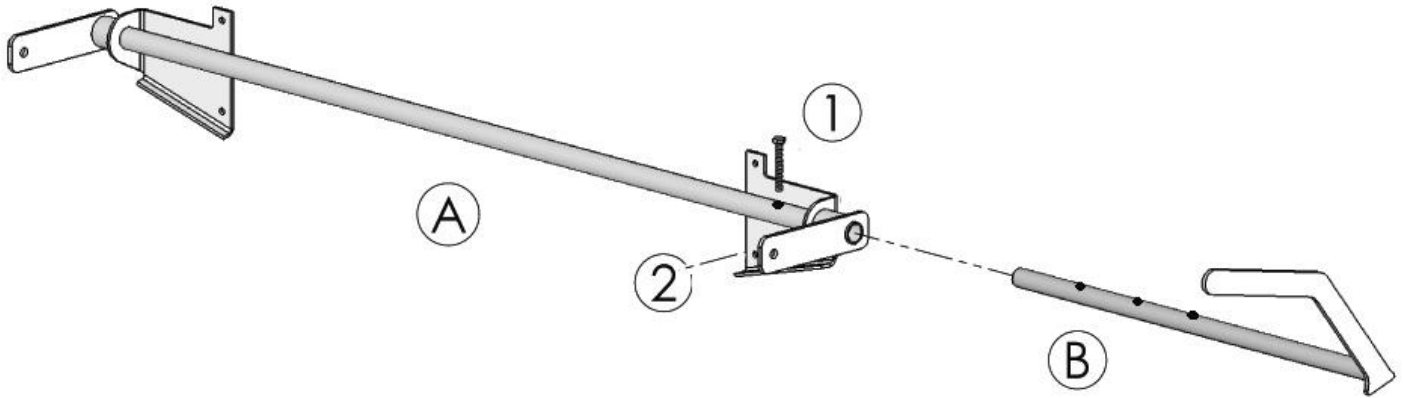

- (A) Dump Lever Assembly  
(B) Dump Lever Handle  
(1) 1/4" x 1 1/4" hex head bolt  
(2) 1/4" nylock nut

- Insert the Dump Lever Handle into the Dump Lever Assembly
- There are 3 holes for spacing the handle to clear the fender of the mower (correctly spacing the handle may wait until the Catcher is fully mounted to mower).
- Insert bolt through holes of the Dump Lever Assembly and Handle.
- Fasten bolt with nut.

**STEP 5:**

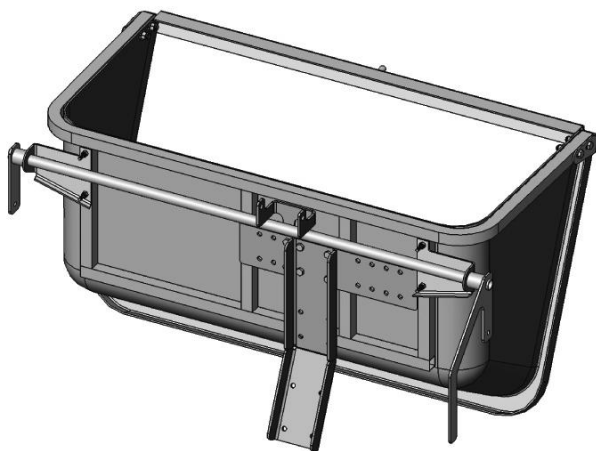
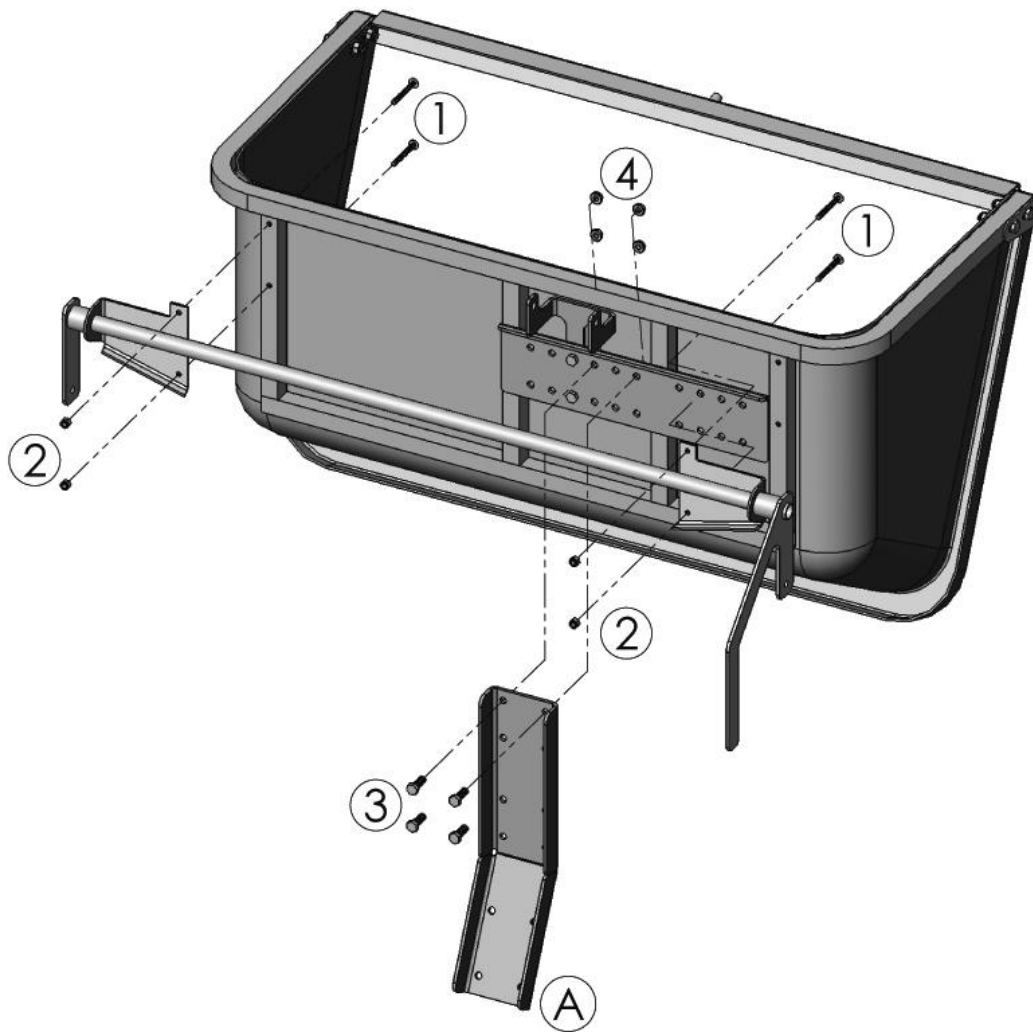

- (A) 212 Channel Mount (Angled)
- (1) 1/4" x 2 1/2" phillips truss head bolt (x4)
- (2) 1/4" nylock nuts (x4)
- (3) 3/8" x 1" hex head bolt (x4)
- (4) 3/8" serrated flange nuts (x4)

- Position the Dump Lever Assembly to the frame of the Catcher Body lining up the holes.
- From the inside of the Catcher, insert the Phillips trust head bolts through the holes and fasten with 1/4" nuts.
- Place the Channel Mount against the plate attached to the Catcher frame. Align the left holes of the Channel mount to the 4<sup>th</sup> set (from

the left) of holes on the plate.

- Insert 3/8" bolts through the Channel Mount and plate.
- Reach behind the plate and thread 3/8" serrated flange nuts to the bolts and tighten the bolts.

**STEP 6:**

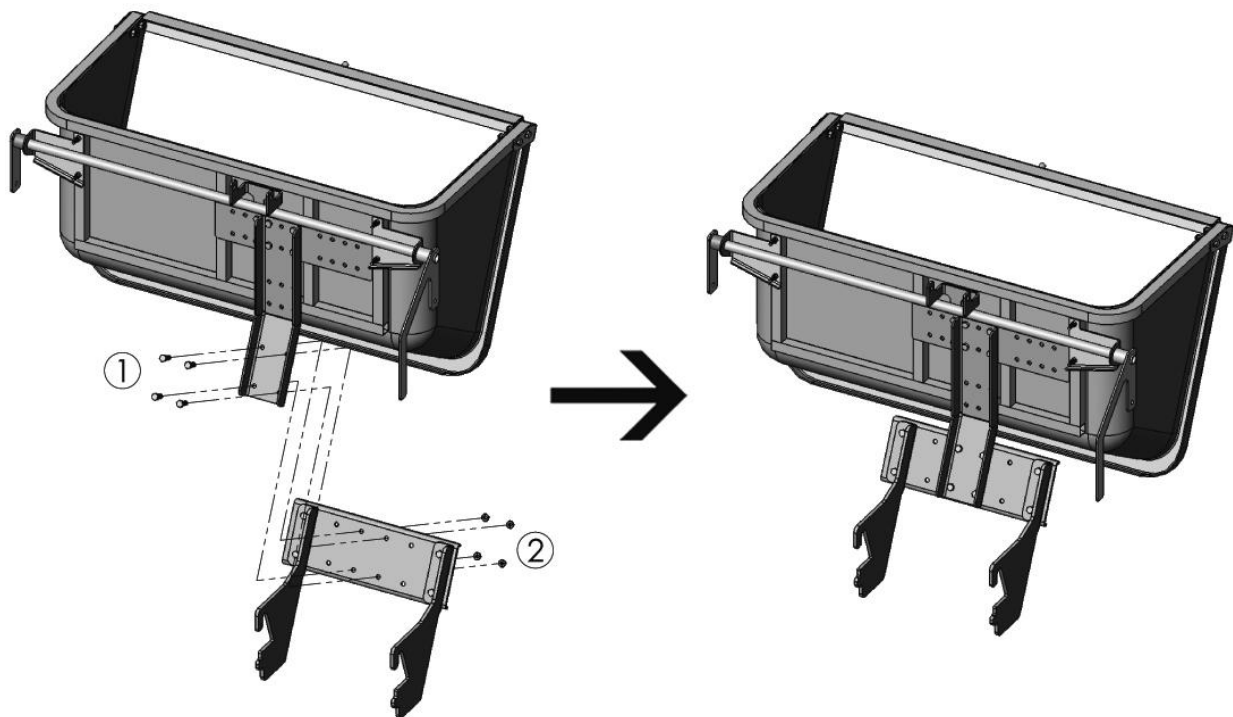

- (1) 3/8" x 1" hex head bolts (x4)
- (2) 3/8" serrated flange nuts (x4)

- Center the Crossplate and Mounts on to the back of the Channel mount.
- Insert 3/8" bolts through the Channel Mount and Crossplate.
- Fasten the bolts with 3/8" nuts.

**STEP 7:**

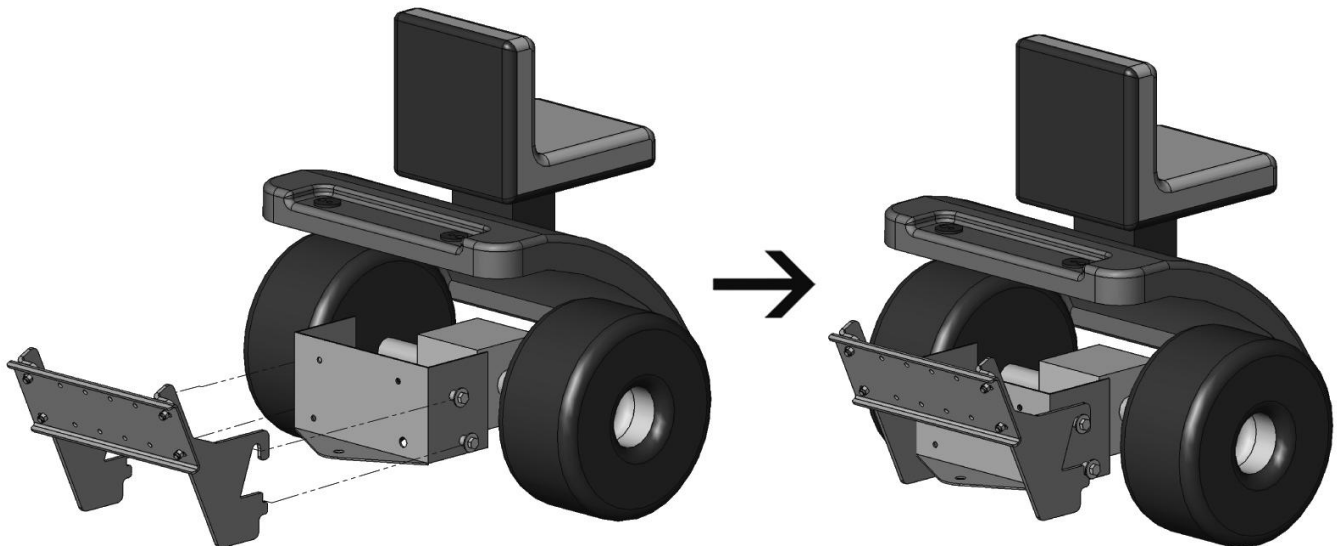

*\* Catcher Body removed from view*

- Lift the current assembly up so that the “hooks” of the side mounts can go over the top tube spacers bolted to the mower.
- The bottom section of the mounts should rest against the bottom tube spacers.

**STEP 8:**

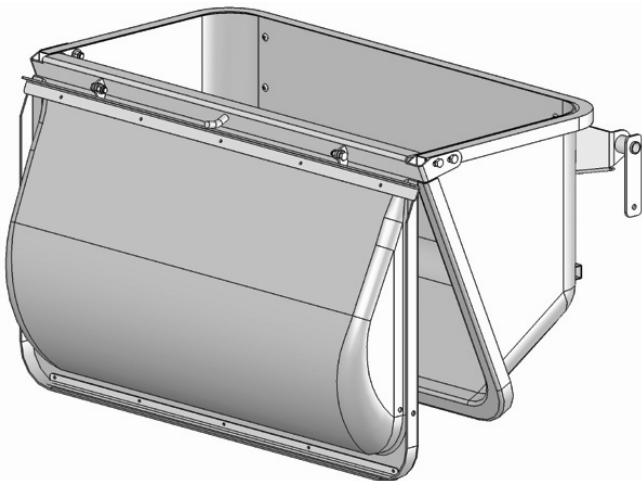
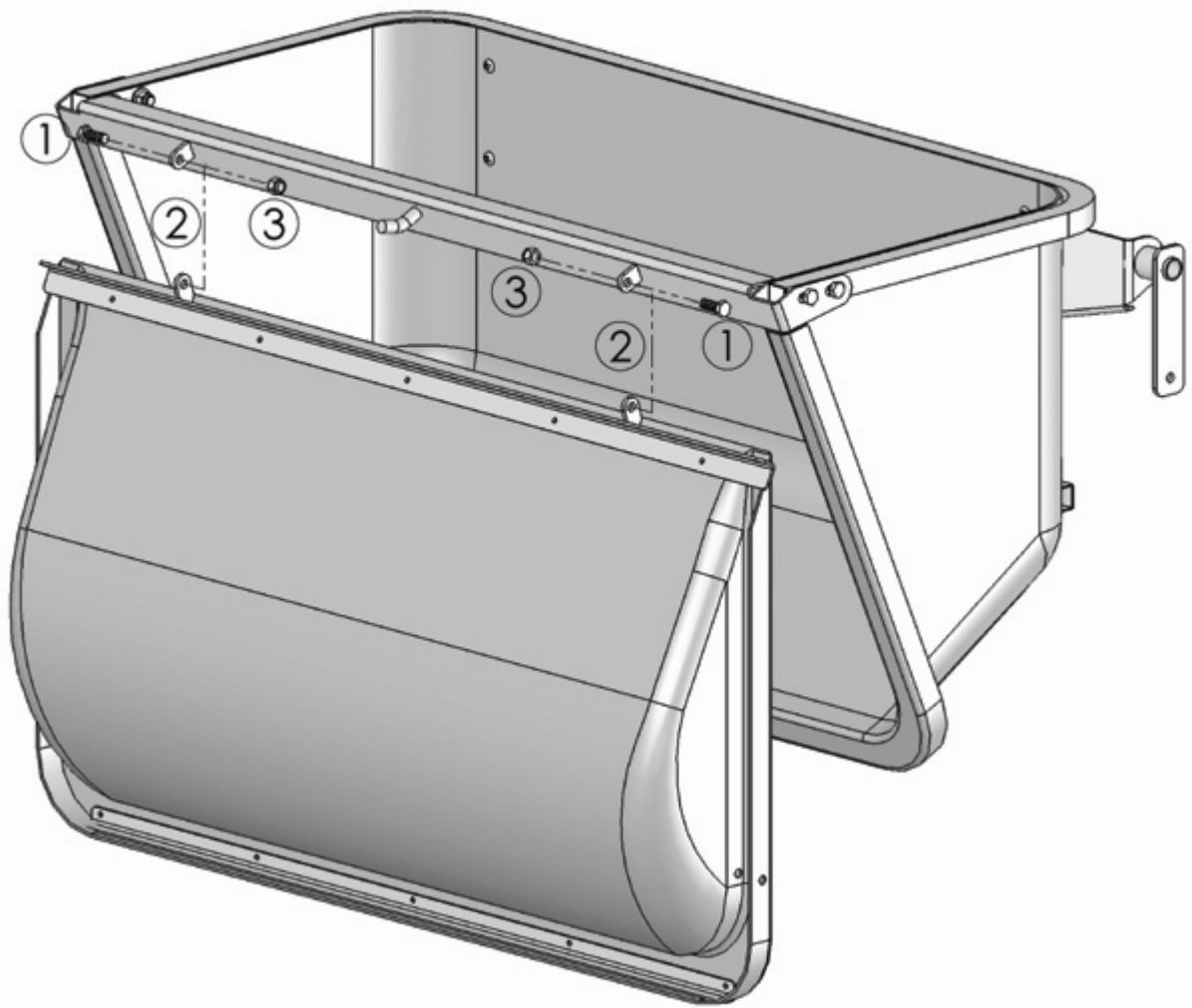

- (1) 3/8" x 1" hex head bolt (x2)
- (2) Hinges (on Door Assembly & Catcher hinge assembly)
- (3) 3/8" nylock nut (x2)

- Line up the hinges on Door Assembly with the hinges on the Catcher Hinge Assembly.
- Keep the hinges on the Door Assembly to the right of the hinges on the Catcher Hinge Assembly.
- Through each set of hinges insert 3/8" bolts.
- Fasten the bolts with 3/8" nuts.

**STEP 9:**

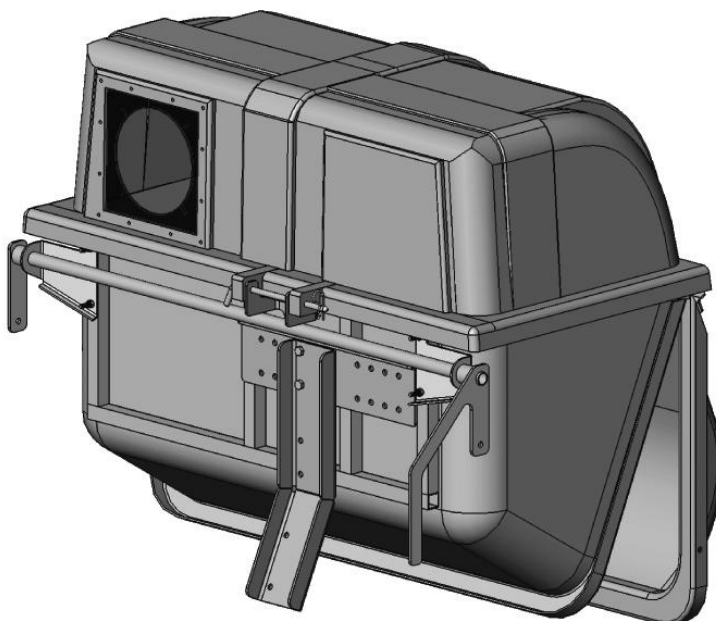
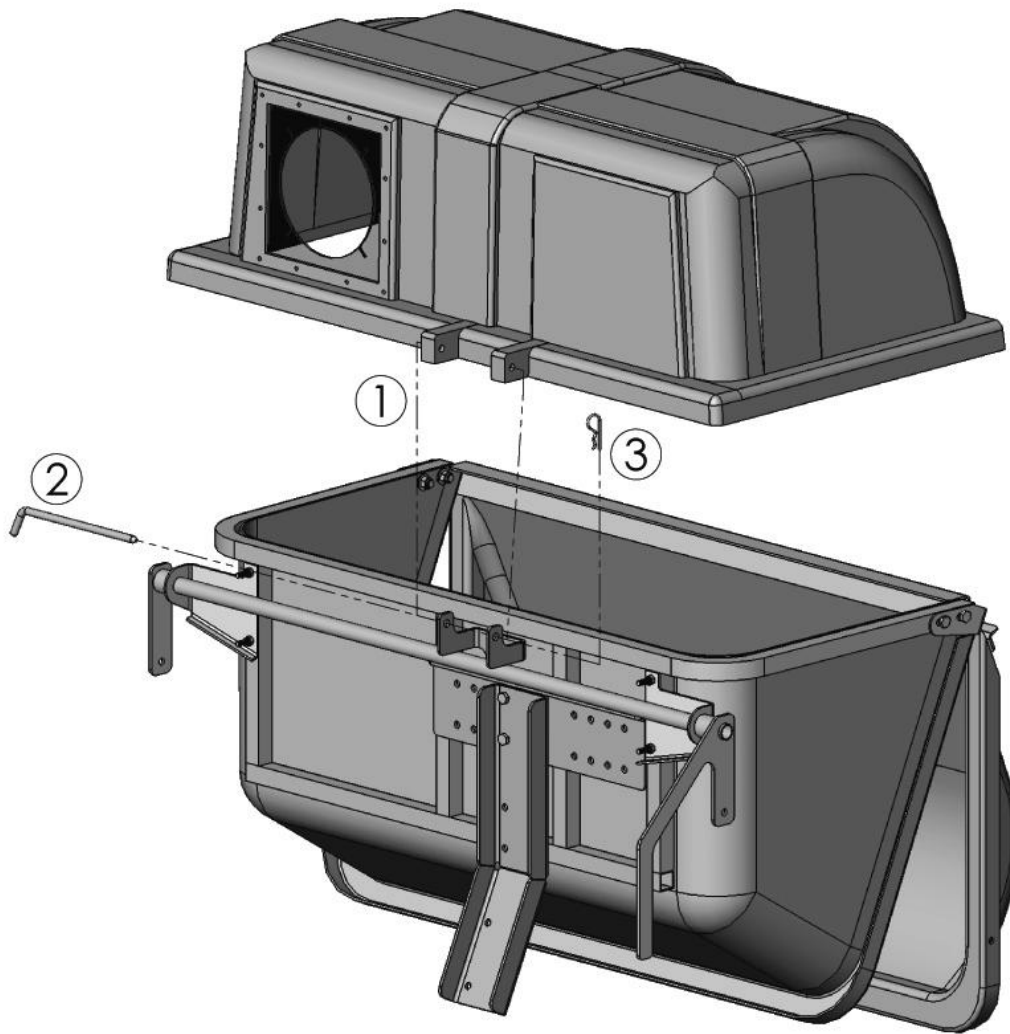

- (1) Hood hinges go in between the Top Catcher Supports
- (2) 3/8" x 7 1/4" bent pin
- (3) Bridge pin 233

- Position the Hood Assembly on top of the Catcher Body.
- Insert the 7 1/4" long bent pin thru the top holes of the Top Catcher Supports and thru the holes of the Hood hinges.
- Secure pin with Bridge pin 233.

**STEP 10:**

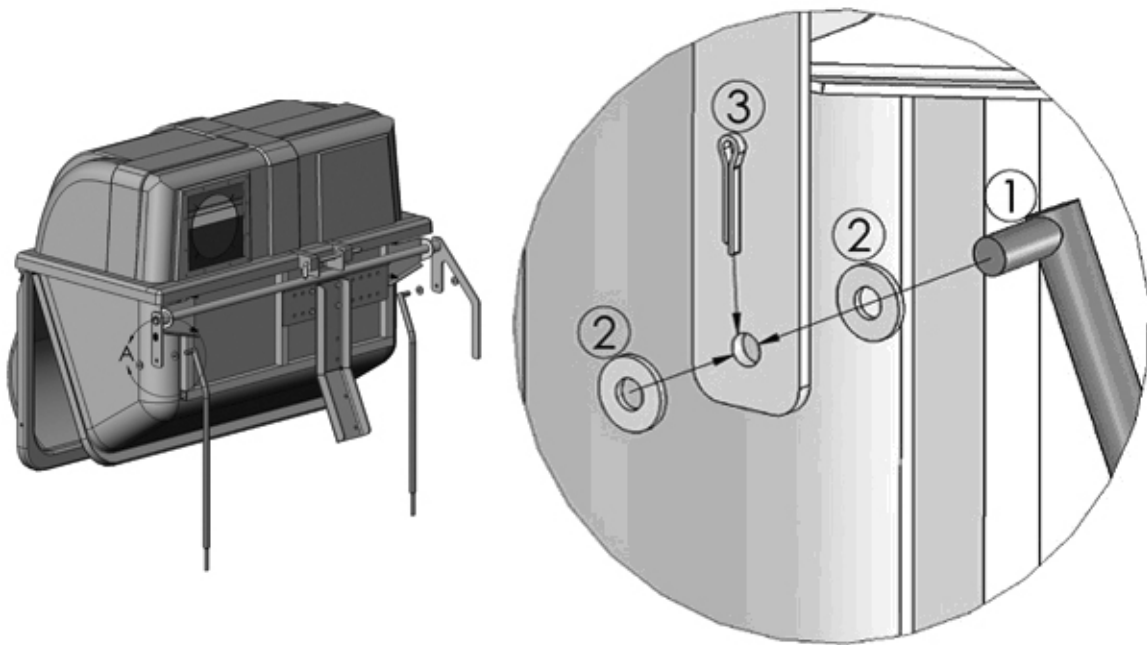

- (1) Hinge Rod – Right, Hinge Rod – Left (not shown)
- (2) 3/8" washers (x4, 2 for each side of the Dump Lever Assembly)
- (3) 1/8" Cotter Pin, 1" long (x2, 1 for each side of the Dump Lever Assembly)

- On the left side of the Dump Lever Assembly (relative to picture above), insert Hinge Rod – Right thru a 3/8" washer and the hole shown in the Dump Lever Assembly.
- Place another washer over the end of the Hinge Rod coming thru the hole. Fasten the Hinge Rod in place with a Cotter Pin.

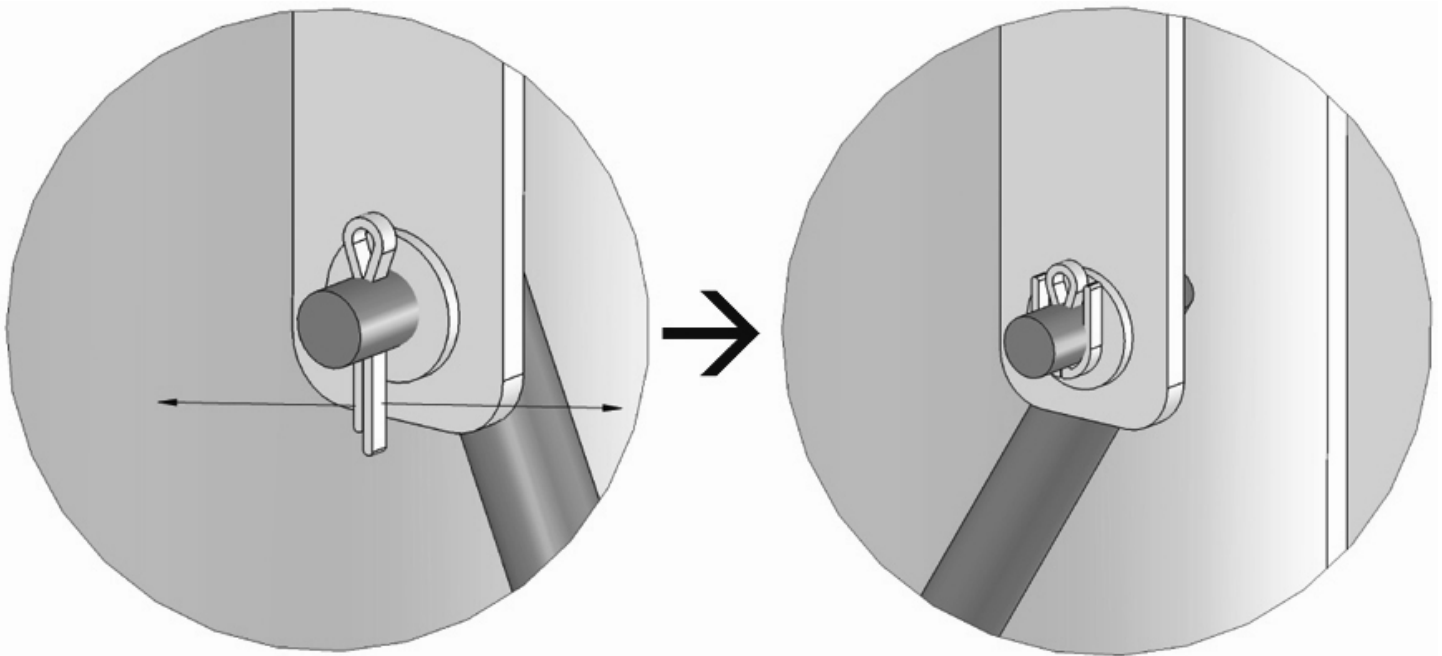

- Use pliers to bend the ends of the cotter pin out, and around the end of the Hinge Rod.
- ***Repeat the above instructions for the opposite side of the Dump Lever Assembly***

**STEP 11:**

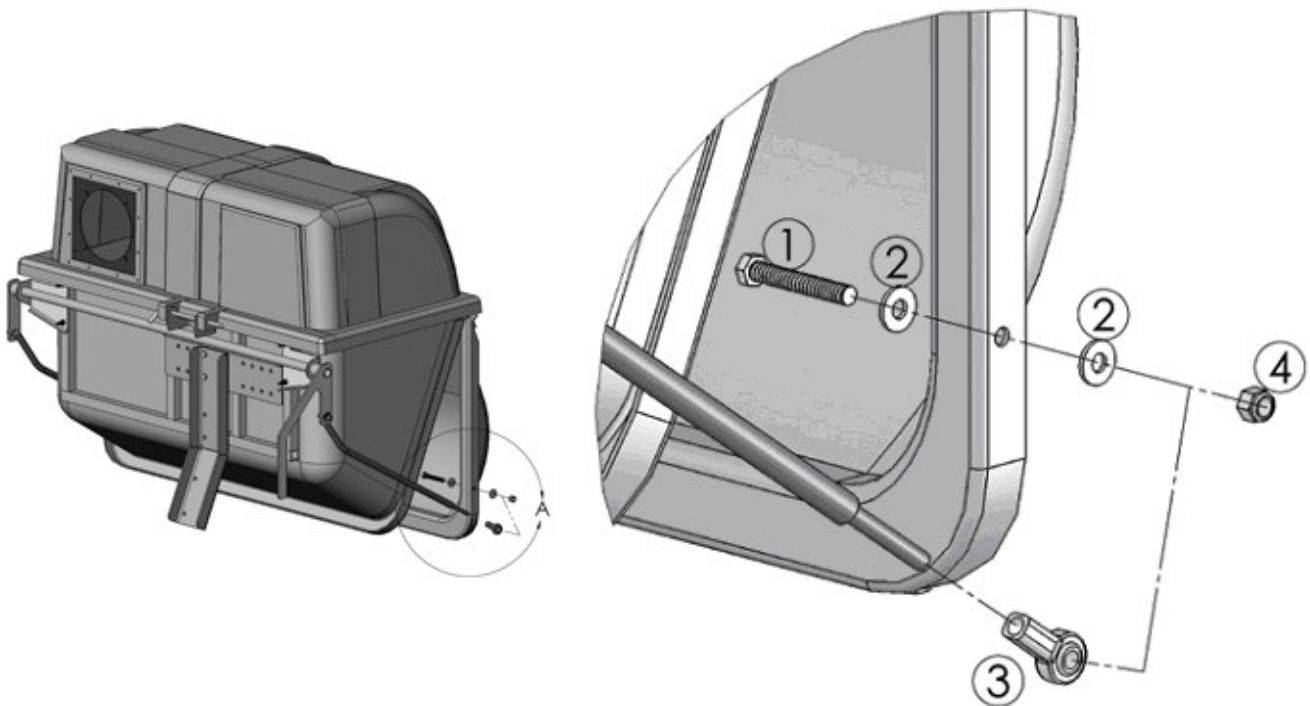

- (1) 3/8" x 2 1/2" hex head bolt (x2, 1 for each side of door assembly)
- (2) 3/8" washers (x4, 1 for each side of door assembly)
- (3) Rod End (x2, 1 for each side of door assembly)
- (4) 3/8" nylock nut (x2, 1 for each side of door assembly)

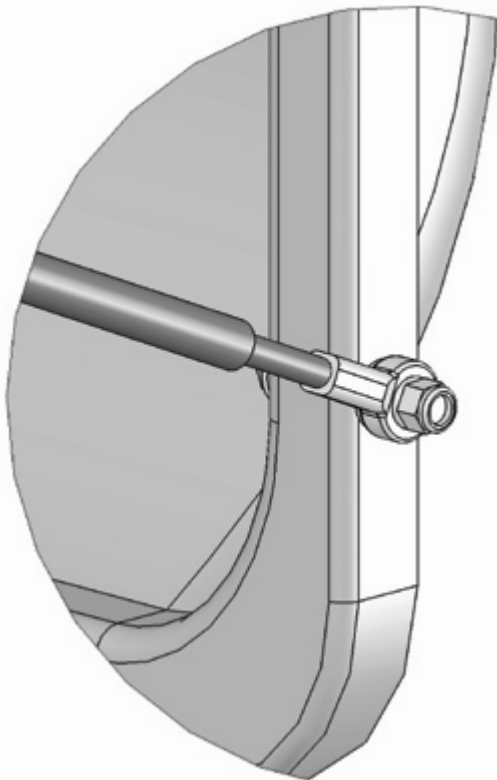

- Screw rod end onto the straight end of the hinge rod. Does not necessarily need to be tight. Adjustments may be required.
- Insert a 3/8" bolt, thru a 3/8" washer from inside the catcher door.
- Place a washer and rod end on the outside of the door over the hole and insert the bolt thru the holes.
- Fasten with a 3/8" nylock nut.
- ***Repeat the instructions above for the opposite side of the catcher door.***

***NOTE: Extra washers are provided to space the rod ends further from the door if necessary.***

***Rod ends may need adjustment by either screwing or unscrewing to change the overall length of the rod. This is required for good closure of the catcher door and to ensure a proper seal.***

***Dump lever handle may need to be bent out slightly, to clear mower fender when operating the dump lever.***

**STEP 12:**

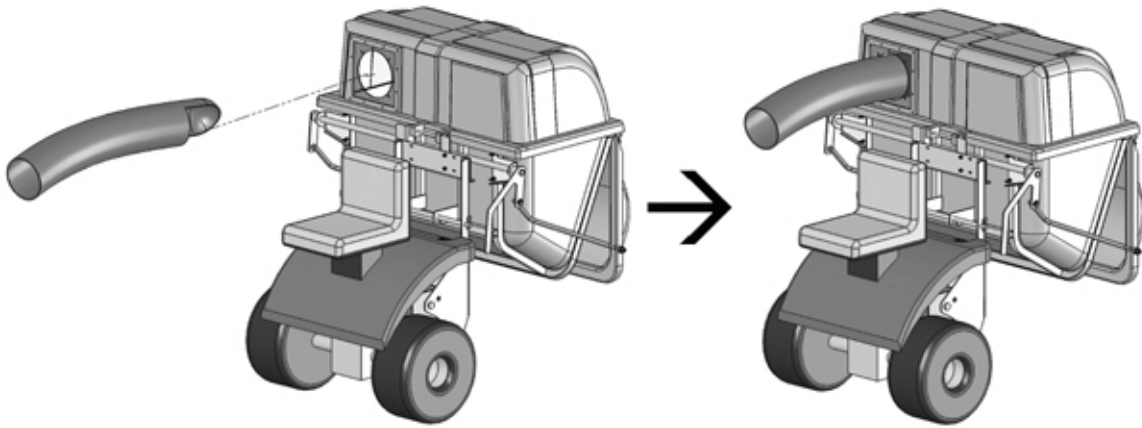

- Attach the intake/chute from the mower deck into the intake seal on the Hood of the Catcher.

*Proper intake provided by John Deere.*

*For 42" deck sizes use John Deere Chute BM21678*

*For 48" deck sizes and up, use John Deere Power Flow Chutes:*

*BM21681 with 7" diameter flexible tube provided by Protero Inc. or*

*BM21682 does not need flexible tube.*

*If provided intake hose is difficult to install onto blower, use soapy water to help lubricate the hose for easier installation.*

## **LIMITED WARRANTY**

We warrant each new Dump N Go catcher to be free from manufacturing defects in normal service for a period of 12 months from the purchase date.

Our obligation under this warranty is expressly limited, at our option, to the replacement or repair at PROTERO Inc. (New Hope, MN), or at a service facility designated by us, of such part or parts as inspected shall disclose to have been defective. This warranty does not apply to defects caused by improper installation, damage, or unreasonable use (including failure to provide reasonable and necessary maintenance).

All warranty claims must be pre-approved. We shall not be liable for any claims or fees not pre-approved. Replacement parts will be sent no charge via UPS Ground. Expedited shipping services are available for an additional fee.

This warranty is void should the product be repaired or modified in any way not authorized by PROTERO Inc.